

USB Dry Contact Input (12 Inputs) Addon

HARDWARE FEATURES

- MicroUSB Interface for power, host connection, and optional programming



WORKS WITH...

- Solarai™ Motor Control Products
 - Flexible Programmable Inputs
 - Multiple Response Profiles
 - Tap and Hold operations
 - Lift and Tilt controls
 - Full Open, Full Close, Stop
 - dedicated Preset Stop buttons (7 possible including fully open and fully closed)
 - Advanced Scene Control
 - Configurable Motor Groups
 - Master
 - Individual
 - Overlapping Groups
 - Network Mappable
 - Simple-Switch™ compatible for out-of-the-box control
- Contact closure/dry contact devices

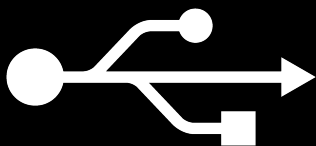

Embedia's USBIF-DCI12 Addon adds up to 12 dry contact inputs to any Solarai™ Group or Plus level motor controller providing additional flexibility related to switch based control and system integration.

Each dry contact input is fully programmable enabling priority based response profiles that can be mapped to any individual motor or group of motors on the network (where applicable). Consecutive contacts can be grouped together for more advanced group and scene control. Up to 12 single contact or any combination of 1-12 contact wall switches can be supported. For example: six 2-contact switches, four 3-contact switches, three 4-contact switches, two 6-contact switches, one 6-contact switch and two 3-contact switches, three 2-contact switches and two 3-contact switches, etc. The USBIF-DCI12 can be mounted in a gang box behind the switches.

Simple-Switch™ default bindings provide out-of-the-box low voltage control for any host or network connected motorized system allowing most common applications to be achieved without the need for any programming. Each set of contacts also has an LED output that can be used

PRODUCT HIGHLIGHTS

- ▶ **OUT-OF-THE-BOX FUNCTIONALITY**
 - ✦ **ZERO-CONFIG SIMPLE-SWITCH™ DEFAULTS**
 - 🔌 **PLUG AND PLAY USB CONNECTION**

to provide local feedback and status when used with supported switches. By default, the DCI12 contacts provide 3 sets of Up/Stop/Down contacts related to Simple-Switch™ channels 1/3, 2/4, and MASTER that control all networked motors on the respective channel.

Closing a contact momentarily will start the motors moving in the corresponding direction. Closing both contacts will stop the motors.

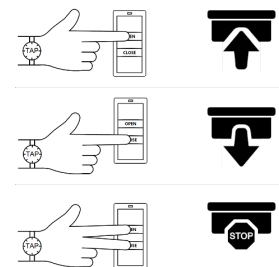



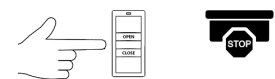
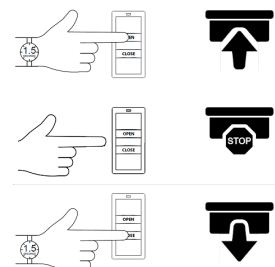

Holding a contact closed for more than 1.5 seconds will move the motors in the corresponding direction until the contact is released.



Technical Specifications

Parameter	Specification
Power and Communication	USB Micro B; 5Vdc Connect to a Solarai™ Group or Plus motor controller using a USB Micro A to Micro B cable (5m/15ft max)
Low Voltage Inputs	12 Contact Closure Inputs; Default configuration is 3 sets of Up/Stop/Down; Wiring recommended to not exceed 1500m/5000ft
Dimensions	78.50mm (3.09") x 53.10mm (2.09") x 25.40mm (1.00")
Enclosure Options	Custom Flame-retardant ABS plastic enclosure

Any dry contact / contact closure switch (such as the SW7-CC line) will work with the USBIF-DCI12. The following push-button switches offered by Embedia have customized labeling that work with the USBIF-DCI12 Out-of-the-Box Simple-Switch™ functionality:

Part Number	SW7-S2-CC-OC	SW7-S3-CC-OSC	SW7-S4-CC-2OC	SW7-S6-CC-2OSC
Description	2-Button Open/Close	3-Button Open / Stop / Close	4-Button Open / Close [x2]	6-Button Open / Stop / Close [x2]
Button Configuration with Standard Engraved Labeling				

Ordering Information

Orderable Part Number	Description
USBIF-DCI12	USB Dry Contact Input (12 Inputs)

ACCESSORIES

Micro-USB Cables

- CABLE-USB-UAMUBM-0.5M
- CABLE-USB-UAMUBM-1.0M
- CABLE-USB-UAMUBM-2.0M
- CABLE-USB-UAMUBM-5.0M

COMPANION PRODUCTS

SW7-CC (Simple-Switch™)

- SW7-S2-CC-OC
 - Open/Close
- SW7-S3-CC-OSC
 - Open/Stop/Close
- SW7-S4-CC-2OC
 - Open/Close x 2
- SW7-S6-CC-2OSC
 - Open/Stop/Close x2
- Any other SW7-CC switch

Third-Party Devices/Switches

- Contact Closures
- Dry Contact Outputs
- Off-the-Shelf Switches
- A/V / BMS Outputs

WARRANTY

All Embedia products carry a standard 2-year product replacement warranty. Extended 5 and 10 year warranties are available.

For more information on any of our products or services, please visit us on the Web at:

<http://www.embedia.com>